

Keech

Keeblok™

Protect high wearing areas and reduce maintenance time and cost with Keeblok™ by Keech. Keeblok™ “chocky bar and buttons” are designed to provide protection against abrasion. Keeblok™ is suitable for bucket and fixed plant such as chute liners. Keeblok™ can be formed and welded onto any flat or curved surface.

Keeblok™ is manufactured from 27 per cent chrome iron, metallurgically bonded to a mild steel backing plate. The chrome iron provides excellent abrasion protection for buckets and fixed plant, while the mild steel ensures the Keeblok™ can be easily welded. Keech Keeblok™ is available in six standard sizes. Custom sizes are available on enquiry.

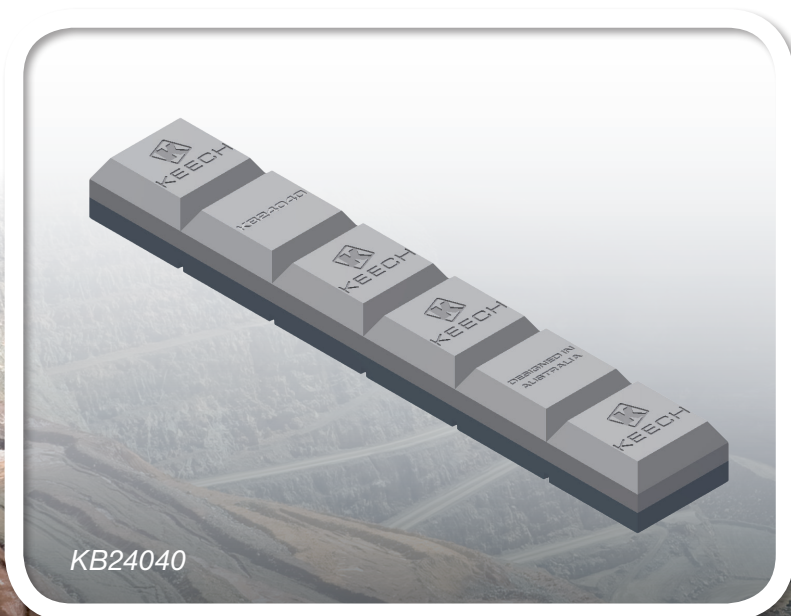

For more information about Keech Australia's range of products, call 1300 4 KEECH or visit www.keech.com.au



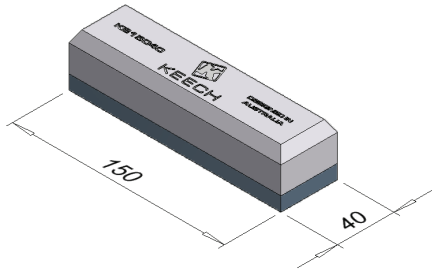

KB15040

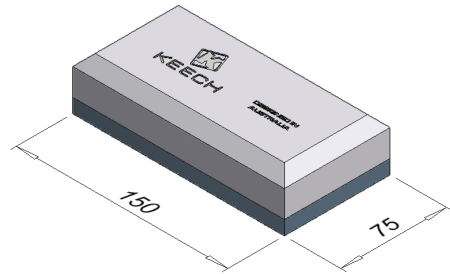

KB15074

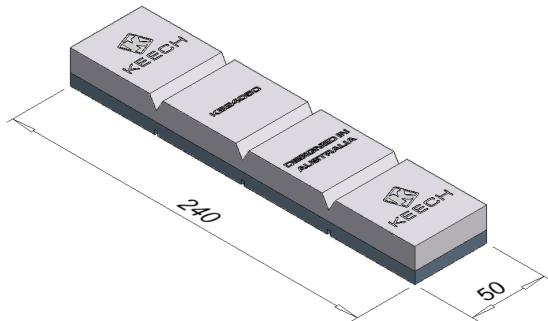

KB24050

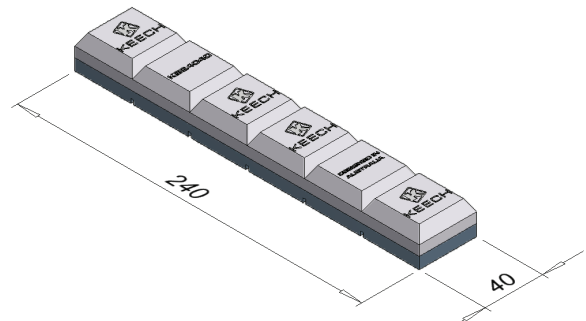

KB24040

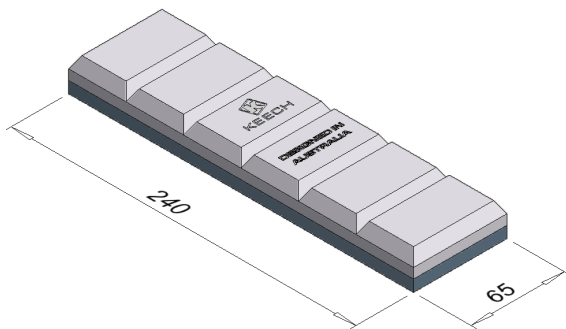

KB24065

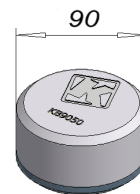

KB9050 (wear button)

Part Number	Size
KB15040	150 x 40 mm
KB15074	150 x 75 mm
KB24050	240 x 50 mm
KB24040	240 x 40 mm
KB24065	240 x 65 mm
KB9050 (wear button)	90 mm dia

Caution: Care should be taken with welding to prevent cracking resulting from heat input.

For more information about Keech Australia's range of products, call 1300 4 KEECH or visit www.keeche.com.au